



TUNGSTEN CARBIDE
MOLD & DIE
硬质合金模具材料

温州宏丰合金有限公司

地址: 浙江省温州经济技术开发区滨海一道1633号
电话: +86-577-86800988 传真: +86-577-86800989
网址: <http://www.wzhf.com> 邮编: 325025
邮箱: wzhf@wzhf.com

WENZHOU HONGFENG ALLOY CO.,LTD

ADD: No. 1633, Binhai First Avenue, Wenzhou Economic and Technological Development Zone, Zhejiang, China
Tel: +86-577-86800988 Fax: +86-577-86800989
Web: <http://www.wzhf.com> P.C: 325025
E-mail: wzhf@wzhf.com



版本: V202212



微信扫一扫, 使用小程序



CONTENT

目录

01

品牌篇 BRAND

- 01/02 企业简介
- 03/04 战略分布
- 05/06 先锋创新力
- 07 尖端生产力
- 08 赋能智造力

- 01/02 Company Profile
- 03/04 Strategic Distribution
- 05/06 Pioneering Creativity
- 07 Sophisticated Productivity
- 08 Intelligence and Creativity

02

产品篇 PRODUCT

- 09/10 牌号信息
- 11 板材
- 12 模芯
- 13 冷墩模
- 14 实心棒
- 15/16 模具应用

- 09/10 Grade Information
- 11 Carbide Plates
- 12 Mold Core
- 13 Blanks for Cold Heading Die Nibs
- 14 Solid Rods
- 15/16 Mold Application

COMPANY PROFILE

企业简介

温州宏丰合金有限公司(简称“温州宏丰合金”)是一家国家高新技术企业,是温州宏丰电工合金股份有限公司的全资子公司(简称“温州宏丰”)。公司坐落于国家级工业园温州经济技术开发区,分别距离温州国际机场6公里、温州高铁站30公里。公司致力于高品质硬质合金系列产品的研发、生产,以及行业专业解决方案的提供。产品作为切削刀具材料、模具材料以及耐磨零件广泛应用在汽车、电子、航空、采掘、工程基建等领域。

公司拥有国际一流的硬质合金制造设备和检测设备、CNAS国家认可实验室、CNC五轴联动自动化装备。温州宏丰合金始终保持着强劲的发展势头,为全球用户提供最高性价比的硬质合金产品和服务,为现代工业领域解决高强度、耐高温、耐磨损问题,提供了优良的产品和完善的解决方案。硬质合金年产1000多吨,客户遍布全球三十多个工业发达国家和地区,同时温州宏丰在美国和德国设立的全资子公司可为海外客户提供必要的技术和业务支持。

Wenzhou Hongfeng Alloy Co., Ltd (hereafter called "Wenzhou Hongfeng Alloy") is a national High-tech corporation, which is wholly-owned subsidiary of Wenzhou Hongfeng Electrical Alloy Co., Ltd (here after called "WZHF"). It is located in National Wenzhou Economical and Technological Development Zone, which is 6 kilometers to Wenzhou International Airport and 30 kilometers to Wenzhou high-speed train station respectively. We are committed to research and produce a series of cemented carbide with high quality and offer professional solution for industries. The products can be used as cutting tool materials, mould materials and wear resistance parts, they are widely used in automobile, electronics, aerospace industry, excavating and engineering infrastructure, etc.

Wenzhou Hongfeng Alloy has world-class carbide manufacturing equipments, detection equipments, CNAS National Approved Laboratory and five-axis CNC auto equipments. We always have maintained a strong momentum of development, providing cost-effective cemented carbide and service for global users, providing excellent products and perfect solutions of high strength, high temperature and wear resistance for modern industry fields. The annual output of cemented carbide are more than 1000 tons. Our customers located in over 30 industrially developed countries and regions. Meanwhile, WZHF has established wholly-owned subsidiaries in USA and Germany which can provide overseas customers with necessary technical and business support.

宏扬广大 丰硕共享

Create exceptional advancement and share our great achievements



CNAS

国家认可实验室
CNAS National
Approved Laboratory

CNC

五轴联动自动化装备
Five-axis CNC
auto equipments

1000+

硬质合金年产1000多吨
Annual output
more than 1000 tons

30+

全球三十多个国家和地区
Sell to more than 30
countries and regions

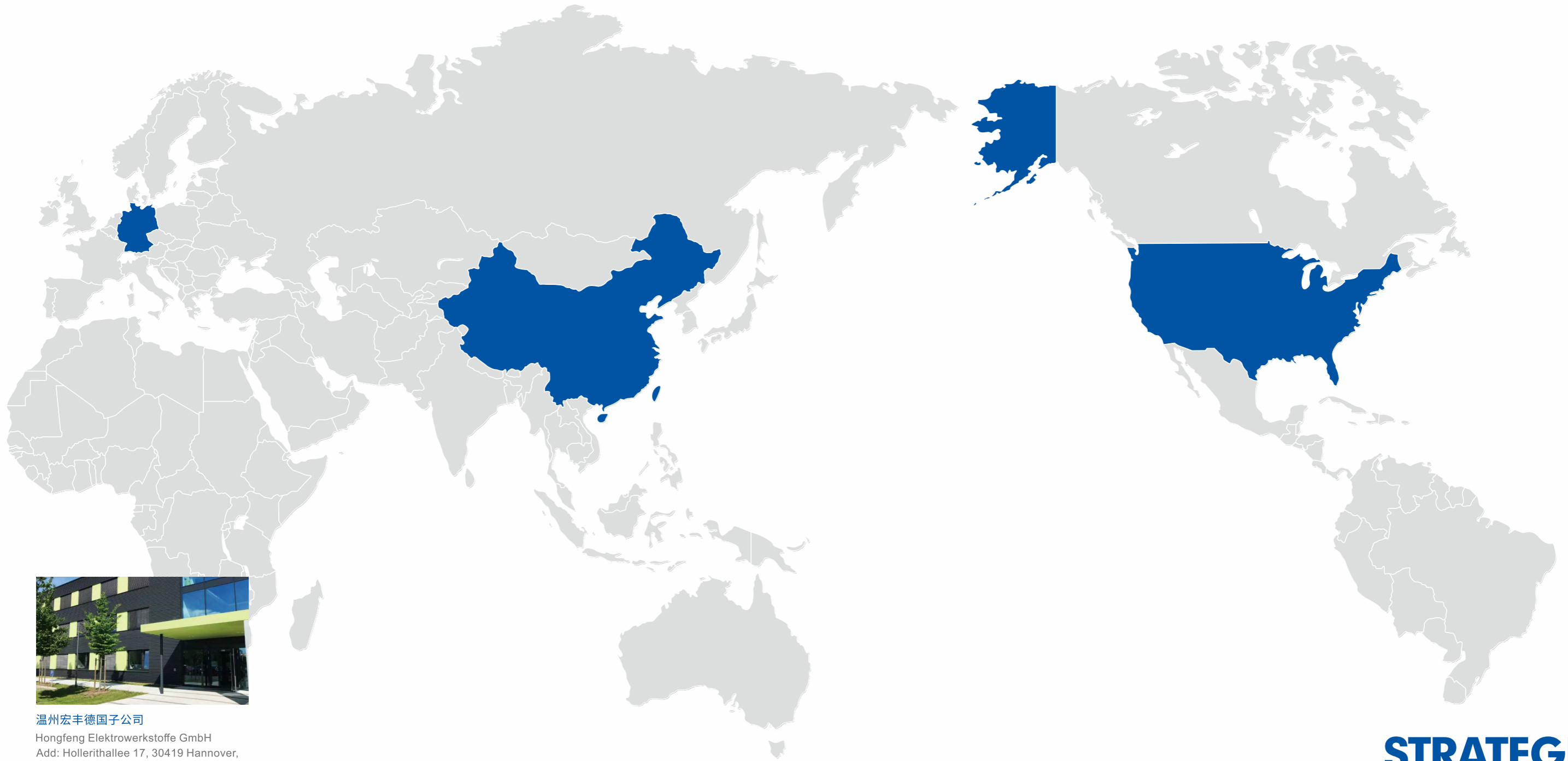

温州宏丰德国子公司
 Hongfeng Elektrowerkstoffe GmbH
 Add: Hollerithallee 17, 30419 Hannover, Germany



温州宏丰合金有限公司
 Wenzhou Hongfeng Alloy Co., Ltd



温州宏丰电工合金股份有限公司
 Wenzhou Hongfeng Electrical Alloy Co., Ltd



温州宏丰金属基功能复合材料有限公司
 Wenzhou Hongfeng Metal-matrix Engineered Composite Material Co.,Ltd



温州宏丰美国子公司
 Hongfeng Composite Material Corp.
 Add: 15 E. Uwchlan Ave, Suite 424 Exton, Pennsylvania 19341,USA

STRATEGIC DISTRIBUTION

战略分布

以用户需求为起点，
我们尽心打造全球战略生产服务体系。

Starting from user demands,
We strive to build a global strategic production service system.

先锋创新力

PIONEERING CREATIVITY



温州宏丰已获授权专利135项，其中国际专利16项，国内发明专利79项，实用新型专利38项，外观设计专利2项。

Wenzhou Hongfeng has been granted 135 patents, including 16 international patents, 79 domestic invention patents, 38 utility model patents and 2 design patents.

尖端生产力

SOPHISTICATED PRODUCTIVITY



PVA低压炉
PVA HIP-Sintering Furnace



喷雾塔
Spray Tower

引进先进设备, 提能增效, 行业领先;
匠心铸就品质, 精益求精, 质量至上。

Introducing advanced equipment, improving capacity and efficiency,
leading the industry. Ingenuity creates quality,
striving for perfection and quality first.



场发射扫描电子显微镜
Field Emission Scanning Electron Microscope



电感耦合等离子体发射光谱仪
Inductively Coupled Plasma Optical Emission Spectrometer



图像尺寸测量仪
Image Dimension Measurement System



圆度仪
Roundness Tester

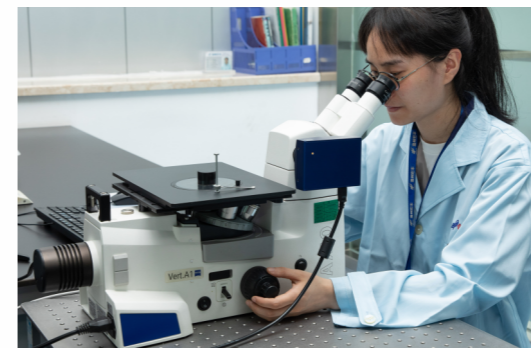

金相显微镜
Metallographic Microscope



万能材料试验机
Universal Material Testing System

以智慧赋能制造, 以数字提升管理。
建立高质量、高标准、高效率的智造体系。

With intelligent manufacturing and digital management.
To establish a high quality, high standard and high efficiency
intelligence manufacturing system.

赋能智造力

INTELLIGENCE AND CREATIVITY

牌号信息

GRADE INFORMATION

分类 Classification	牌号 Grade	钴含量 Cobalt Content (Co%)	硬度 Hardness (HRA)	密度 Density (g/cm ³)	抗弯强度 TRS (N/mm ²)
拉丝模具材质牌号 Grade for Wire drawing die	HM12AX	6	93.3	14.80	2600
	HM12X	6	92.3	14.90	2800
	HM14	7	90.5	14.85	2800
	HU20	10	91.8	14.40	3500
冲压模具材质牌号 Grade for Stamping die	HU20	10	91.8	14.40	3500
	HM24C	12	88.1	14.31	3200
	HM30AX	15	91.0	13.85	4000
	HM40C	20	83.5	13.50	2600
锻造成型模具材质牌号 Grade for Forging die	HM30	15	86.5	14.00	3000
	HM40C	20	83.5	13.50	2600
	HM44C	22	82.5	13.40	2400
无磁模具材质牌号 Grade for Non-magnetic die	YN15	15(Ni)	85.3	14.19	2700
	YN7	7(Ni)	92.0	14.91	2300

晶粒度 Grain Size (μm)	推荐用途 Application Recommended
亚微细 SUBMICRON	适用于拉伸直径在3.0mm以下的钢丝、铜丝，且表面光洁度要求很高的有色合金线材或棒材的高速拉丝拉拔。 Applicable to the hard high-speed drawing of steel wire, copper wire with the diameter less than 3mm, and non-ferrous metal pipe or rods with high requirements of surface finish.
细 FINE	用于拉伸应力不大的条件下，拉伸直径小于6.0mm的钢丝及有色金属线材。 Applicable to the steel wire and non-ferrous metal wire with the diameter less than 6mm under the condition of less tensile stress.
中 MEDIUM	用于拉伸应力较大情况下，拉伸直径在20mm以下钢、有色金属及其合金线材或棒材；亦适合拉伸直径在10mm以下管材。 Applicable to the steel, non-ferrous metal wire or rods with the diameter less than 20mm, and also pipes with the diameter less than 10mm under the condition of biggish tensile stress.
亚微细 SUBMICRON	适用于拉伸直径在10.0mm以下的钢丝、铜丝，且表面光洁度要求很高的有色合金线材或棒材的高速拉丝拉拔。 Applicable to the hard high-speed drawing of steel wire, copper wire with the diameter less than 10mm, and non-ferrous metal pipe or rods with high requirements of surface finish.
亚微细 SUBMICRON	适用于冲裁载荷较小的五金件冲压，耐磨性高，模具寿命长，主要以小冲头为主。 Applicable to metal sheets stamping with small blanking load, with high wear resistance and long mould application life, mainly for making small punches.
粗 COARSE	用于冲压各种五金件，属于中粗粒度，高韧性材质，通用性强，适用范围广的标准牌号。 Applicable to all kinds of metal sheet stamping, medium coarse grain size, high toughness, highly optimized for general use and wide application range.
超细 ULTRAFINE	用于冲压不锈钢和铜合金，高耐磨性和高韧性，适用于半导体和各种电子零件冲压。 Applicable for stainless steel and copper alloy stamping. High hardness and fine toughness for semi-conductor and electronics stamping.
粗 COARSE	适用于标准件、紧固件、五金工具行业对一般钢材、铁制品的冷冲，裁剪。 Applicable to standard parts, fasteners and metal tool industry for cold punching and cutting of general steel and iron.
中 MEDIUM	高韧性冷锻模 High toughness cold heading die
粗 COARSE	高韧性冷锻模 High toughness cold heading die
粗 COARSE	高韧性冷锻模 High toughness cold heading die
中 MEDIUM	无磁性，用在铁件铆钉冲压和磁材成型型腔。 Non-magnetic properties, for iron rivet stamping and magnetic material forming cavities.
中 MEDIUM	无磁性，用于铜件铆钉、铁件铆钉冲压及制作冲裁刀。 Non-magnetic properties, for copper rivet, iron rivet stamping and blanking die making.

板材

CARBIDE PLATES

长 L x 宽 W (mm)	长宽公差 (mm) Length & Width Tolerance	厚度 T (mm)	高度公差 (mm) Height Tolerance
100x100	+0/+5	3~90	+0.0/+0.5
100x150	+0/+5	3~65	+0.0/+0.5
150x150	+0/+5	3~60	+0.0/+1.0
200x200	+0/+5	3~60	+0.0/+1.0
250x250	+0/+5	10~50	+0.0/+1.0
300x300	+0/+5	10~50	+0.0/+1.0

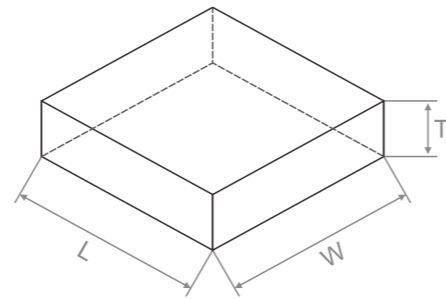

注:其他尺寸可定制

Remark:Other dimension customized available

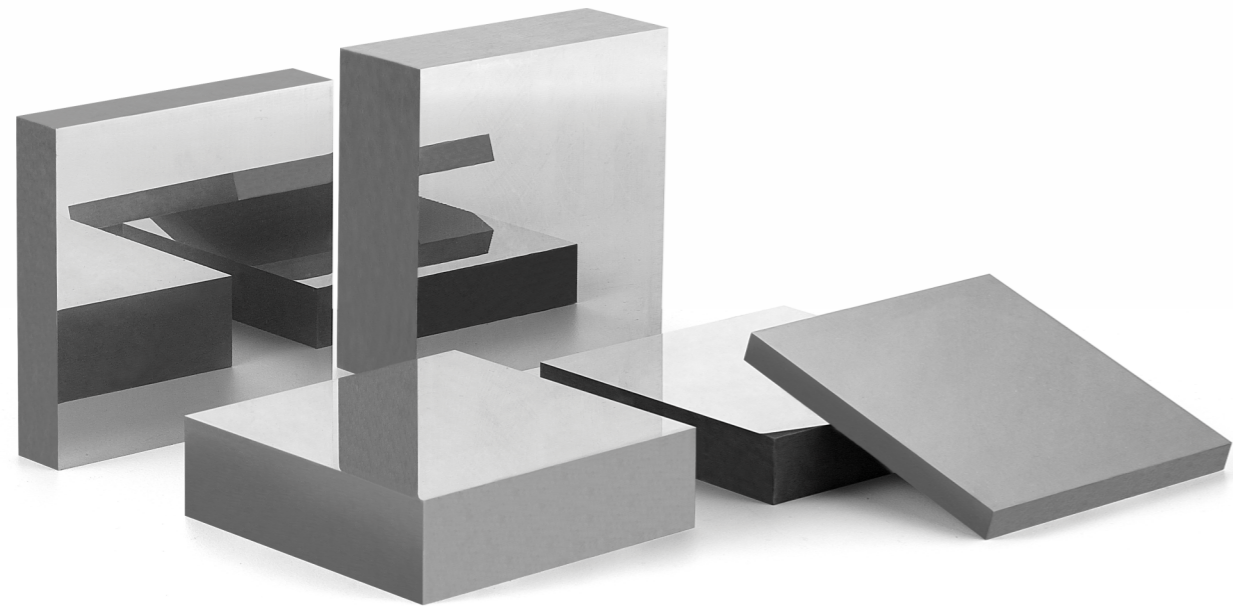

模芯

MOLD CORE

直径 ϕD (mm)	高度 H (mm)
$\phi 10$	<20
$\phi 12$	<30
$\phi 15$	<40
$\phi 16$	<40
$\phi 20$	<45
$\phi 25$	<45
$\phi 30$	<45
$\phi 40$	<50
$\phi 45$	<50

注:其他尺寸可定制

Remark:Other dimension customized available

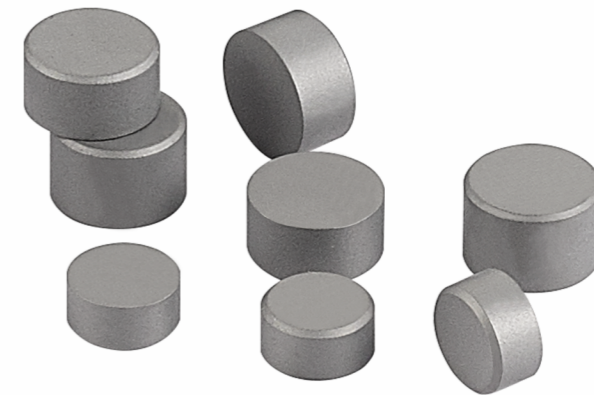
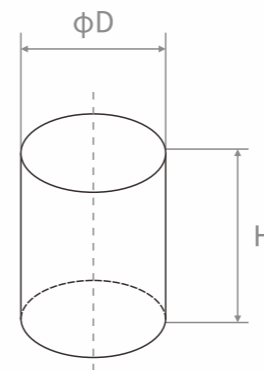

冷镦模

BLANKS FOR COLD HEADING DIE NIBS

直径 ϕD (mm)	高度 H (mm)	内径 ϕd (mm)
$\phi 15$	<40	$\phi 1\sim 10.0$
$\phi 16$	<40	$\phi 1\sim 10.0$
$\phi 20$	<45	$\phi 3\sim 10.0$
$\phi 25$	<45	$\phi 3\sim 17.7$
$\phi 30$	<45	$\phi 3\sim 24.0$
$\phi 35$	<45	$\phi 3\sim 25.0$
$\phi 40$	<50	$\phi 3\sim 25.0$
$\phi 50$	<50	$\phi 3\sim 25.0$
$\phi 60$	<50	$\phi 3\sim 25.0$

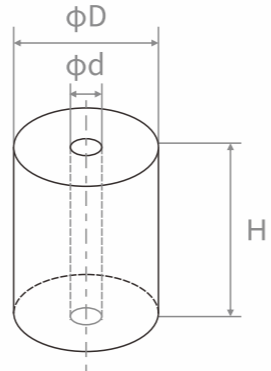

注:其他尺寸可定制

Remark:Other dimension customized available

直径 ϕD (mm)	高度 H (mm)	内径 W/IC (mm)
$\phi 15\sim 40$	<45	可定制 Customized Available

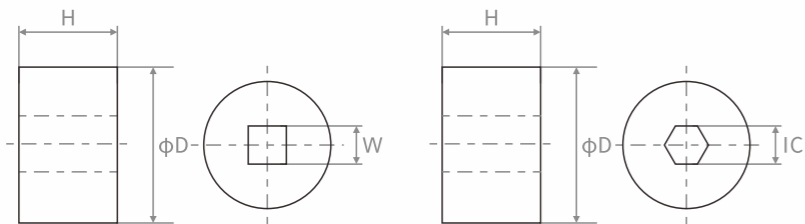

实心棒

SOLID RODS

直径 ϕD (mm)	长度 L (mm)	精磨棒 Ground rods
$\phi 3.3$	330/310	可定制 Customized Available
$\phi 4.3$	330/310	
$\phi 6.3$	330/310	
$\phi 8.3$	330/310	
$\phi 10.3$	330/310	
$\phi 12.3$	330/310	
$\phi 14.3$	330/310	
$\phi 16.3$	330/310	
$\phi 18.3$	330/310	
$\phi 20.3$	330/310	
$\phi 22.3$	330/310	
$\phi 24.3$	330/310	
$\phi 26.3$	330/310	
$\phi 28.3$	330/310	
$\phi 30.3$	330/310	
$\phi 32.3$	330/310	
$\phi 34.3$	330/310	

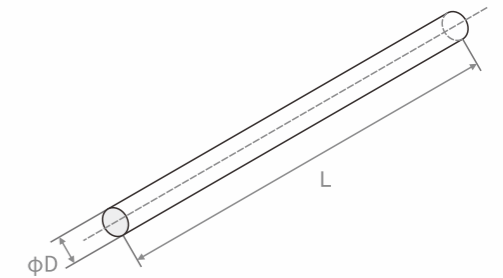

注:其他尺寸可定制

Remark:Other dimension customized available

MOLD APPLICATION

模具应用

